



**Chicago
Pneumatic**



**People.
Passion.
Performance.**

RX Hydraulic Breakers
for a Full Range of Tough Jobs

CHICAGO PNEUMATIC RIG-MOUNTED HYDRAULIC BREAKERS ARE RELIABLE, RUGGED AND BUILT TO LAST.

There's no time for downtime on the job. That's why Chicago Pneumatic RX hydraulic breakers are built to power through the toughest tasks day in and day out, year after year. The smart design has fewer components with only two moving parts for easy maintenance, long service life and quiet operation.



NEW DESIGN



OLD DESIGN

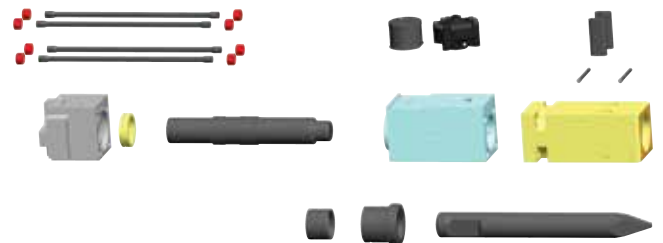



Every light-, medium- and heavy-duty RX breaker shares these features for high performance, excellent efficiency and outstanding value:

HYBRID TECHNOLOGY

The combined gas/oil working principle behind all RX breakers ensures the optimum transmission of energy from the piston to the working tool to deliver the best possible efficiency and high-impact energy.

POWER BOOSTER

Rather than waste recoil energy, Chicago Pneumatic technology in RX breakers converts it to reusable energy that enhances percussive performance to deliver more power from the same hydraulic input.

BREAKER BOX GUIDING SYSTEM

Minimizes recoil forces for less strain on the carrier, operator and breaker. All RX breakers deliver sound power levels among the lowest in the market.

INTERNAL CONTROL VALVE

Protects sensitive parts to ensure maximum efficiency and reliability.

Of course, those features are just the beginning. You'll find plenty more working benefits on every model, helping you get exactly what you need for your application. Then simply attach the RX breaker to the carrier of your choice and know you have what it takes to get the job done smartly, efficiently and reliably.



Mini Hydraulic Breakers

APPLICATIONS: Used in light demolition, landscaping, building renovation and road construction



CARRIER WEIGHT

1.3-15 t

STATE-OF-THE-ART DESIGN

Fewer parts for optimized durability and easy serviceability

TWO-IN-ONE DESIGN

Cylinder and tool holder are one piece, eliminating strain and risk of seizures

REPLACEABLE CYLINDER SLEEVE

Quick and easy exchange cuts repair time and costs

NO HIGH PRESSURE ACCUMULATOR

Increases reliability

NO TIE RODS

Eliminates bending stress for reliability and means no special tools needed for service

ONE-PIECE FLOATING WEAR BUSH

Ensures maximum uptime and fast, easy field replacement

CENTRAL LUBRICATION POINT

Quick and easy lubrication cuts maintenance costs

EASY POWER

Easier positioning of working tool increases productivity

MODEL	Service Weight ¹		Carrier Weight Class ²		Operating Pressure		Oil Flow Rate		Impact Rate	Working Tool Diameter		Sound Power Level	Part No.
	kg	lb	t	lb	bar	psi	l/min	gpm	bpm	mm	in	dB(A)	-
RX2	94	207	1.3-3	2,900-6,600	110-130	1,600-1,890	15-30	4-9	560-1600	42	1.65	109 ³ /81 ⁴	8460 0500 38
RX3	166	329	2.1-4.5	4,600-9,900	110-140	1,600-2,030	30-50	8-13	670-1500	52	2.05	111 ³ /83 ⁴	8460 0500 39
RX4	233	470	2.9-6	6,400-13,200	110-140	1,600-2,030	35-60	9-16	520-1300	62	2.44	113 ³ /85 ⁴	8460 0500 40
RX6	284	600	4.2-9	9,300-19,800	110-140	1,600-2,030	45-75	12-20	530-1200	70	2.76	114 ³ /86 ⁴	8460 0500 41
RX8	380	816	5.2-12	11,500-26,500	120-150	1,740-2,180	60-90	16-24	530-1000	80	3.15	115 ³ /87 ⁴	8460 0500 42
RX11	550	1,210	9-15	19,800-33,100	120-150	1,740-2,180	70-100	18-26	590-1100	80	3.15	116 ³ /87 ⁴	3363 1095 21
RX12	550	1,500	9-15	19,000-33,000	120-150	1,885-2,176	70-100	21-29	590-1100	90	3.54	116 ³ /87 ⁴	3363 1168 36

While Supplies Last

Coming Soon

¹ Breaker and breaker box with standard adapter plus working tool.

² Weights apply to standard carriers only. Any variances must be approved by Chicago Pneumatic and/or the carrier manufacturer prior to attachment.

³ Sound power level guaranteed.

⁴ Sound pressure level (r=10m)

Important: EN ISO 3744 in accordance with directive 2000/14/EC. Full details of measurement are available in the Safety and Operating Instructions for the product.

Medium Hydraulic Breakers

APPLICATIONS: Used in medium demolition, building renovation, road construction, rock excavation, quarrying



CARRIER WEIGHT
12-28 t

STATE-OF-THE-ART DESIGN
Fewer parts for optimized durability and easy serviceability

TWO-IN-ONE DESIGN
Cylinder and tool holder are one piece, eliminating strain and risk of seizures

REPLACEABLE CYLINDER SLEEVE
Quick and easy exchange cuts repair time and costs

NO HIGH PRESSURE ACCUMULATOR
Increases reliability

NO TIE RODS
Eliminates bending stress for reliability and means no special tools needed for service

ACTIVE VENTILATION PORT
Protects the carrier and breaker by reducing dust intake into the hydraulic circuit

DOUBLE TOOL RETAINER BARS
Ensures optimal working tool guidance

POWER STOP
Protects your investment by reducing strain on the breaker and carrier under tough conditions

OPTIONAL FEATURES
Increase service life with automatic lubrication device CP-Lube and Dust Wiper

MODEL	Service Weight ¹		Carrier Weight Class ²		Operating Pressure		Oil Flow Rate		Impact Rate	Working Tool Diameter		Sound Power Level	Part No.
	kg	lb	t	lb	bar	psi	l/min	gpm	bpm	mm	in	dB(A)	-
RX14	800	1,760	12-19	22,000-37,500	150-170	2,180-2,470	100-120	26-32	650-850	100	3.93	115 ³ /85 ⁴	3363 1049 61
RX18	1200	2,650	15-24	33,100-52,900	150-170	2,180-2,470	120-140	32-37	550-720	120	4.72	120 ³ /90 ⁴	3363 1052 39
RX22	1500	3,310	17-28	37,500-61,700	150-170	2,180-2,470	140-160	37-42	520-680	135	5.31	122 ³ /93 ⁴	3363 1051 01

¹ Breaker and breaker box with standard adapter plus working tool.

² Weights apply to standard carriers only. Any variances must be approved by Chicago Pneumatic and/or the carrier manufacturer prior to attachment.

³ Sound power level guaranteed.

⁴ Sound pressure level (r=10m)

Important: EN ISO 3744 in accordance with directive 2000/14/EC. Full details of measurement are available in the Safety and Operating Instructions for the product.





RX30

Heavy Hydraulic Breakers

APPLICATIONS: Used in medium and heavy industrial demolition, building renovation, road construction, rock excavation, quarrying



CARRIER WEIGHT
20-75t

POWER CONTROL PLUS

Enables operator to adjust the operation mode of the breaker to the application to optimize productivity. It's a combined stroke length and start-up mode switching valve that the operator can change in the field without opening the hydraulic circuit.

ACTIVE VENTILATION PORT

Protects the carrier and breaker by reducing dust intake into the hydraulic circuit

DOUBLE TOOL RETAINER BARS

Ensures optimal working tool guidance

REINFORCED BREAKER BOX DESIGN

Higher wear protection by additional rock claws

OPTIONAL FEATURES

Increase service life with automatic lubrication device CP-Lube and Dust Wiper

MODEL	Service Weight ¹		Carrier Weight Class ²		Operating Pressure		Oil Flow Rate		Impact Rate PowerStop Plus	Impact Rate EasyPower Plus	Working Tool Diameter		Sound Power Level	Part No.
	kg	lb	t	lb	bar	psi	l/min	gpm	bpm	bpm	mm	in	dB(A)	-
RX26	1800	3,970	20-33	44,100-72,800	150-170	2,180-2,470	130-180	34-48	380-650	400-800	140	5.51	122 ³ /92 ⁴	3363 1123 91
RX30	2200	4,850	25-40	55,100-88,200	150-170	2,180-2,470	150-200	40-53	380-620	450-800	150	5.90	122 ³ /93 ⁴	3363 1124 31
RX38	2600	5,732	29-46	64,000-101,500	160-180	2,320-2,610	180-220	48-58	380-590	530-800	155	6.11	124 ³ /94 ⁴	3363 1126 06
RX46	3000	6,610	35-55	63,900-101,400	160-180	2,320-2,610	220-270	58-71	380-580	540-800	165	6.50	124 ³ /95 ⁴	3363 1138 76
RX54	4200	9,260	45-70	88,200-154,300	160-180	2,320-2,610	250-320	66-85	380-570	550-800	180	7.09	126 ³ /96 ⁴	3363 1138 38

¹ Breaker and breaker box with standard adapter plus working tool.

² Weights apply to standard carriers only. Any variances must be approved by Chicago Pneumatic and/or the carrier manufacturer prior to attachment.

³ Sound power level guaranteed.

⁴ Sound pressure level (r=10m)

Important: EN ISO 3744 in accordance with directive 2000/14/EC. Full details of measurement are available in the Safety and Operating Instructions for the product.



Original Parts

make your breaker even more effective.

Chicago Pneumatic tools are manufactured to the highest quality standards with full control of that process. All tools are made from a nickel-chrome alloy that has been optimized for breaking applications. Each tool is precision formed and temper hardened for excellent wear resistance.

Working Tools

MODEL	Working Length		Total Length		Moil Point (Conical)	Chisel (Cross)	Blunt Tool
	mm	in	mm	in	Part no.	Part no.	Part no.
RX2	265	10.43	425	16.73	4211 1050 01	4211 1050 02	4211 1050 03
RX3	320	12.60	530	20.87	4211 1051 01	4211 1051 02	4211 1051 03
RX4	350	13.78	590	23.23	4211 1052 01	4211 1052 02	4211 1052 03
RX6	380	14.96	665	26.18	4211 1053 01	4211 1053 02	4211 1053 03
RX8	415	16.34	745	29.33	4211 1054 01	4211 1054 02	4211 1054 03
RX11	390	15.35	745	29.33	4211 1054 01	4211 1054 02	4211 1054 03
RX12	390	15.35	745	29.33	4211 1054 01	4211 1054 02	4211 1054 03
RX14	495	19.49	895	35.24	4211 1055 38	4211 1055 39	4211 1055 36
RX18	540	21.26	995	39.17	4211 1055 33	4211 1055 34	4211 1055 31
RX22	565	22.24	1050	41.34	4211 1055 27	4211 1055 28	4211 1055 25
RX26	585	23.03	1115	43.90	4211 1055 03	4211 1055 04	4211 1055 01
RX30	590	23.23	1225	48.23	4211 1055 09	4211 1055 10	4211 1055 07
RX38	615	24.23	1270	50	4211 1055 59	4211 1055 60	4211 1055 57
RX46	670	26.38	1365	53.74	4211 1055 15	4211 1055 16	4211 1055 13
RX54	735	28.94	1500	59.06	4211 1055 21	4211 1055 22	4211 1055 19

While Supplies Last

Coming Soon

Chisel Paste

Description	Size	Part no.
Chisel paste cartridge for CP-Lube	30 x 500 g	3363 0949 10
Standard Grease Gun Grease	12 pack, 14oz. tube	3363 0949 13

Carrier classes

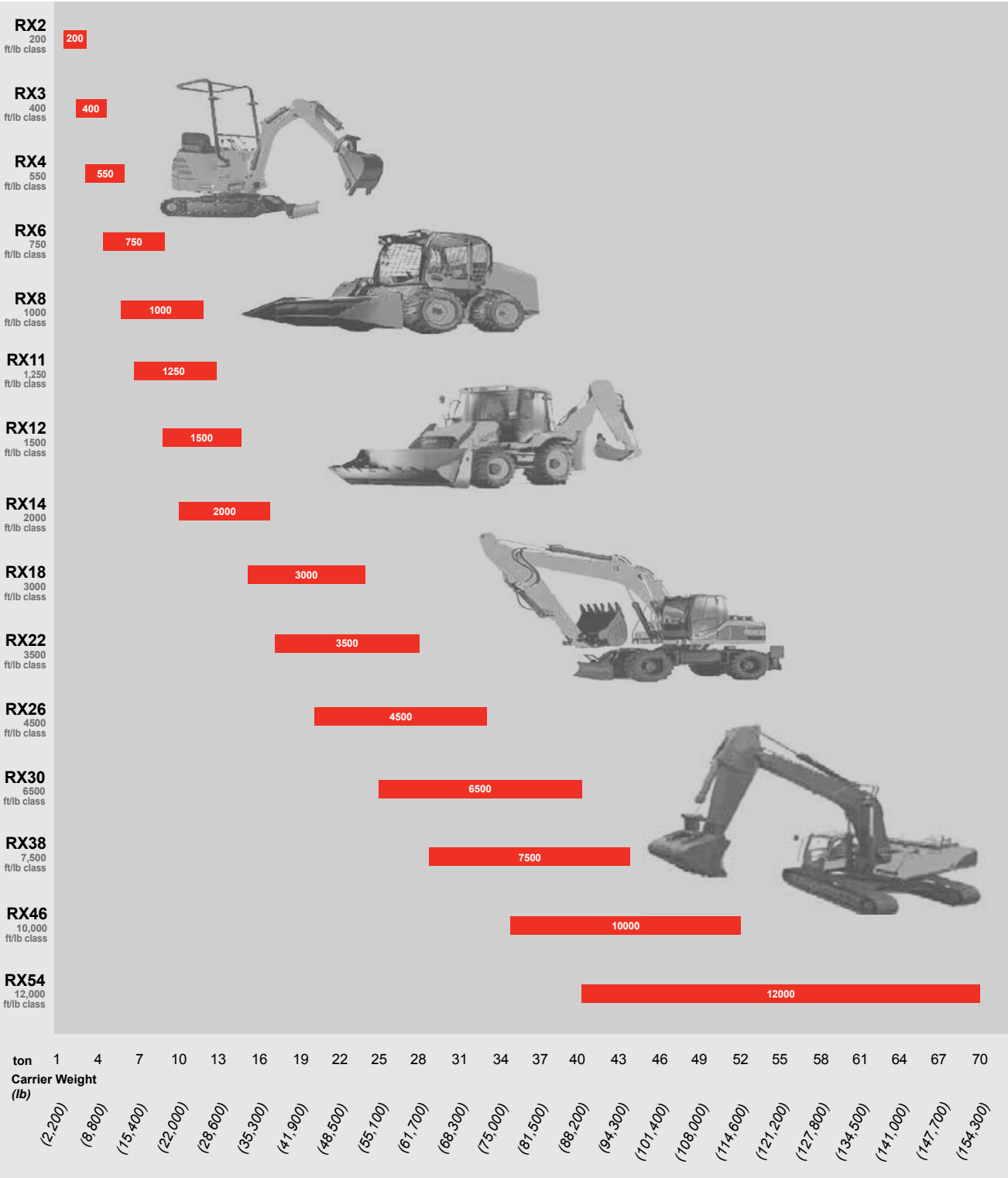



Over 100 Years of Experience

Since 1901 the Chicago Pneumatic name has represented high-performance tools and equipment designed for an extensive range of applications. Today, Chicago Pneumatic has a global reach, with local customer centers around the world. Chicago Pneumatic tools and air compressors are tailored to the needs of the industrial, vehicle service, and construction markets. Every day we develop and manufacture new products that are meant to meet your demands not only today, but tomorrow as well.

For more information contact your CP Partner:

Use only authorised parts. Any damage or malfunction caused by the use of unauthorised parts is not covered by Warranty or Product Liability.